



**CANTERBURY, NSW**  
6 Clisdell Avenue

**3**  
BED

**1**  
BATH

**2**  
CAR

**Devine**

**PEACEFULLY LOCATED \*\*\*SOLD - \$806,000\*\*\***

Situated in a peaceful cul-de-sac, nestled on 499.5sqm approx is this freestanding home located in a family orientated neighbourhood ready for you to move straight in. Conveniently located close to parklands, schools and transport.

**Features:**

- \* Updated eat in timber kitchen with electric appliances
- \* Study off dining with split air conditioning
- \* Sun filled lounge with split air conditioning
- \* 3 bedrooms all with mirrored built ins, decorative ceilings and picture railings
- \* Ample storage

**Auction**

Contact: David Diamantopoulos  
02 9569 8000  
0418 569 800  
Type: House  
Sold Date: 17/08/2013  
<https://www.devinere.com.au>

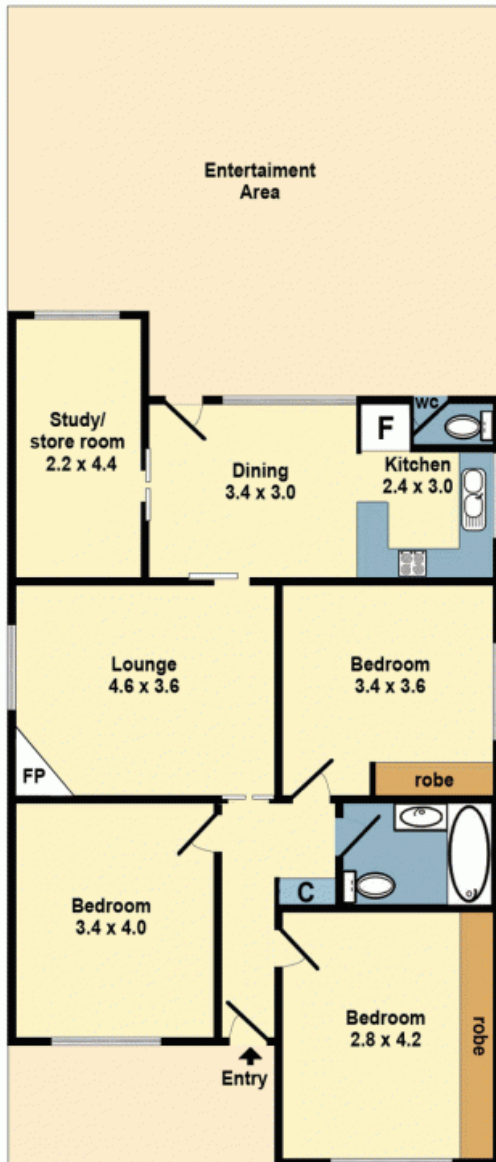
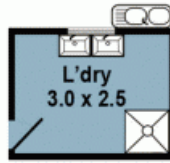

6 Clisdell Avenue, Canterbury

DISCLAIMER: PLANS SHOWN ARE FOR PRESENTATION PURPOSE AND ARE NOT PART OF ANY LEGAL DOCUMENT. ALL MEASUREMENTS AND FIGURES ARE APPROXIMATE.

Plans shown are only indicative of layout. Dimensions are approximate.

**CANTERBURY, NSW**  
6 Clisdell Avenue