



**CANTERBURY, NSW**  
13/1-11 Canterbury Road

**2**  
BED

**2**  
BATH

**1**  
CAR

**Devine**

### Rear and Sunny Split Level Apartment

Set in the rear of the complex and accessed from quiet Princess St, this elevated, dual level apartment is sure to impress. Entry to the first level with lounge and dining areas, tiled throughout. A house sized, modern kitchen with gas cooking and dishwasher and stairs leading up to the bedrooms.

A huge master bedroom and generous second bedroom, both with built in robes, plus second upstairs balcony and main bathroom as well as ensuite make up the upstairs accommodation. With a downstairs security parking space and storage cage.

Features such as security intercom and with a location on the border of Hurlstone Park, it is convenient to local schools, shops and transport. For something different from so many new apartments you will see on the market today, this one is a must see!

**For Sale \$699,000**

**View:** Sat, 19 Jan 2019 @12:00 pm - 12:30 pm  
Sat, 26 Jan 2019 @12:00 pm - 12:30 pm

**Contact:** Adrian Abrook  
02 9569 8000  
0412 569 800  
David Diamantopoulos  
02 9569 8000  
0418 569 800

**Type:** Apartment  
<https://www.devinere.com.au>

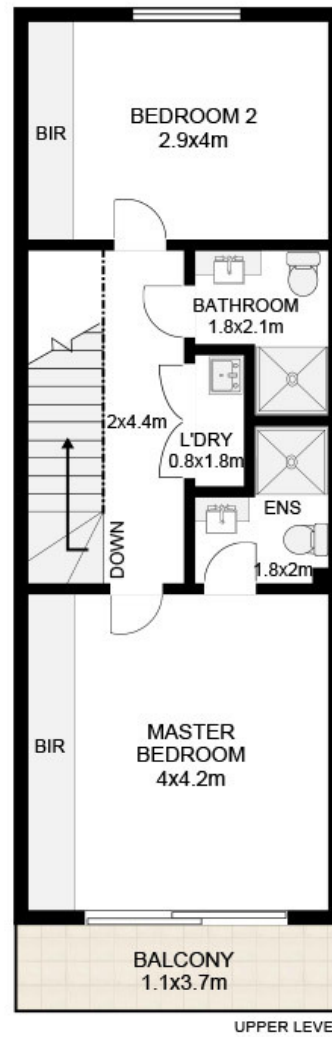
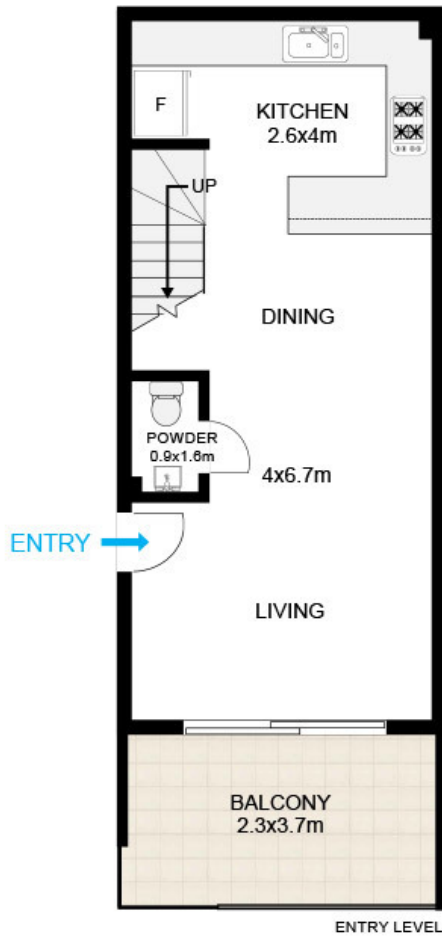
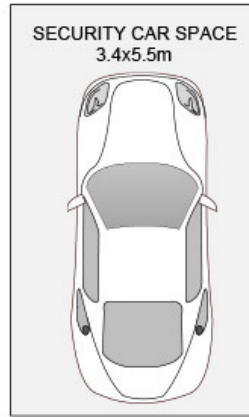
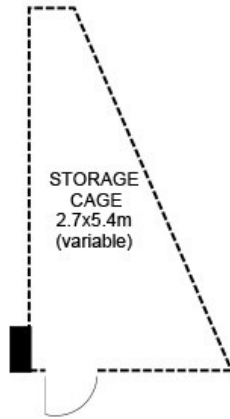

## 13/1-11 Canterbury Road Canterbury

Floor plan by DG Life

The following floor plan is shown for presentation purposes only and is not part of any legal document. All measurements and figures are approximate.



Plans shown are only indicative of layout. Dimensions are approximate.

**CANTERBURY, NSW**  
13/1-11 Canterbury Road